

Areas Sheet 3

Q. 1 Find the length of side in each square, given their area;

- a) 36m^2 b) 225m^2 c) 42.92m^2 d) 27.5m^2

Q. 2 Find the length or width in each of the following rectangles, given area and one side;

- a) area = 46m^2 b) area = 25.7m^2 c) area = 32.92m^2
L = 9m W = 3.7m W = 5.36m

Q. 3 Given area and height find the base of each Triangle;

- a) 12.6m^2 , H = 6m b) 25.4m^2 , H = 12m c) 18.79m^2 , H = 3.4m

Q. 4 Given the area find the radius in each circle;

- a) area = 26m^2 b) area = 15.7m^2 c) area = 22.42m^2

Q. 5 Find the area of these shapes;

a)

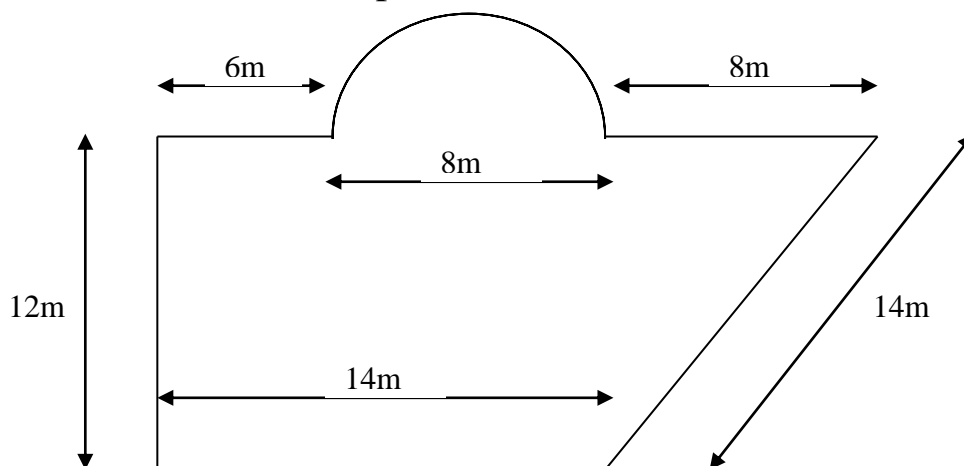

b)

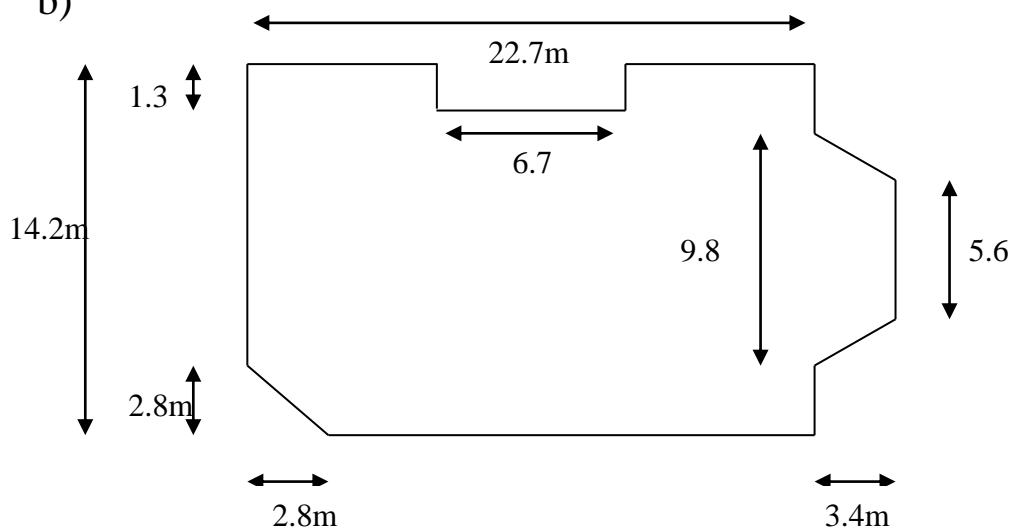

Areas Sheet 3(Answers)



Q. 1 a) 6m b) 15m c) 6.551m d) 5.244m

Q. 2 a) W = 5.111m b) L = 6.946m c) L = 6.142m





Q. 3 a) 4.2m b) 4.233m c) 11.053m

Q. 4 a) 2.877m b) 2.236m c) 2.671m

Q. 5 a)

	$12 \times 14 =$	168
	$\frac{1}{2}(12 \times 8) =$	48
	$\frac{1}{2}(\pi \times 4^2) =$	<u>25.133</u>
		241.133m²

b)

	$22.7 \times 14.2 =$	322.34
	$\frac{1}{2}(2.8 \times 2.8) =$	(- 3.92)
	$6.7 \times 1.3 =$	(- 8.71)
	$\frac{9.8 + 5.6}{2} = 7.7 \times 3.4 =$	<u>26.18</u>
		335.89m²